







Terminal block type E, increased air clearances and creepage distances for combination motor controller Type E according to UL508 for circuit breaker Size S0 !!! Phased-out product !!! Successor is SIRIUS 3RV2 Preferred successor type is >>3RV2928-1H<<



General technical data		
product brand name		SIRIUS
product designation		Terminal block
design of the product		Type E acc. to UL
size of the circuit-breaker		S0
insulation voltage with degree of pollution 3 at AC rated value	V	690
ambient temperature		
• during storage	°C	-50 ... +80
• during operation	°C	-20 ... +60
ampacity maximum	A	40
Installation/ mounting/ dimensions		
width	mm	44.8
height	mm	38.9
depth	mm	73.6
suitability for use enables assembly of self-protected combination motor controllers (type E) acc. to UL 508 note		a construction with 3RV1915 bus bars is not possible
Connections/ Terminals		
type of electrical connection for main current circuit		screw-type terminals
type of connectable conductor cross-sections		
• for main contacts		
— solid		2x (1 ... 10 mm <sup>2</sup> )
— stranded		2x (2.5 ... 16 mm <sup>2</sup> ), 1x (1.5 ... 25)
— finely stranded		
— with core end processing		1x (1 ... 16 mm <sup>2</sup> ), 2x (1 ... 10 mm <sup>2</sup> )
• at AWG cables for main contacts		1x (14 ... 3), 1x (16 ... 3), (14 ... 6), (16 ... 3)
Certificates/ approvals		
certificate of suitability		CE / UL / CSA / CCC
General Product Approval	Declaration of Conformity	Marine / Shipping
		
		
	EG-Konf.	
Marine / Shipping	other	



[Confirmation](#)

other



#### Further information

Information- and Downloadcenter (Catalogs, Brochures,...)

<https://www.siemens.com/ic10>

Industry Mall (Online ordering system)

<https://mall.industry.siemens.com/mall/en/en/Catalog/product?mlfb=3RV1928-1H>

Cax online generator

<http://support.automation.siemens.com/WW/CAXorder/default.aspx?lang=en&mlfb=3RV1928-1H>

Service&Support (Manuals, Certificates, Characteristics, FAQs,...)

<https://support.industry.siemens.com/cs/ww/en/ps/3RV1928-1H>

Image database (product images, 2D dimension drawings, 3D models, device circuit diagrams, EPLAN macros, ...)

[http://www.automation.siemens.com/bilddb/cax\\_de.aspx?mlfb=3RV1928-1H&lang=en](http://www.automation.siemens.com/bilddb/cax_de.aspx?mlfb=3RV1928-1H&lang=en)

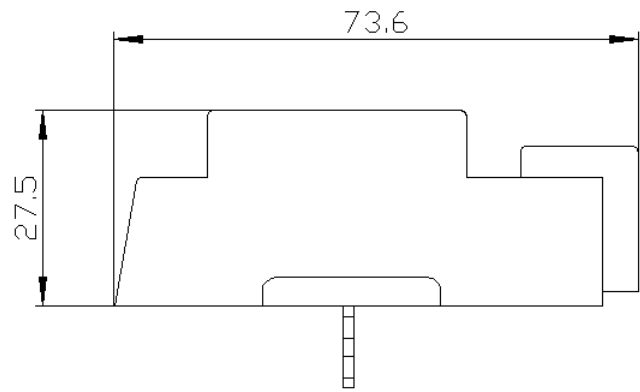
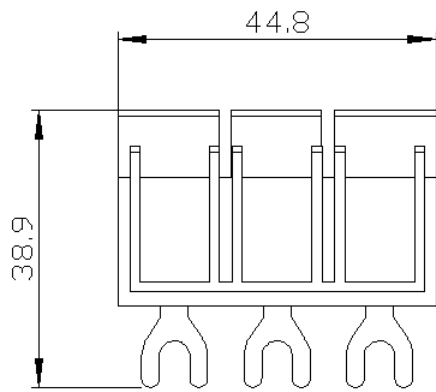

last modified:

1/18/2021 